

Amendment No. 3413
Bylaw No. 30Z80
Council Approval: 12 May 1980

SCHEDULE B

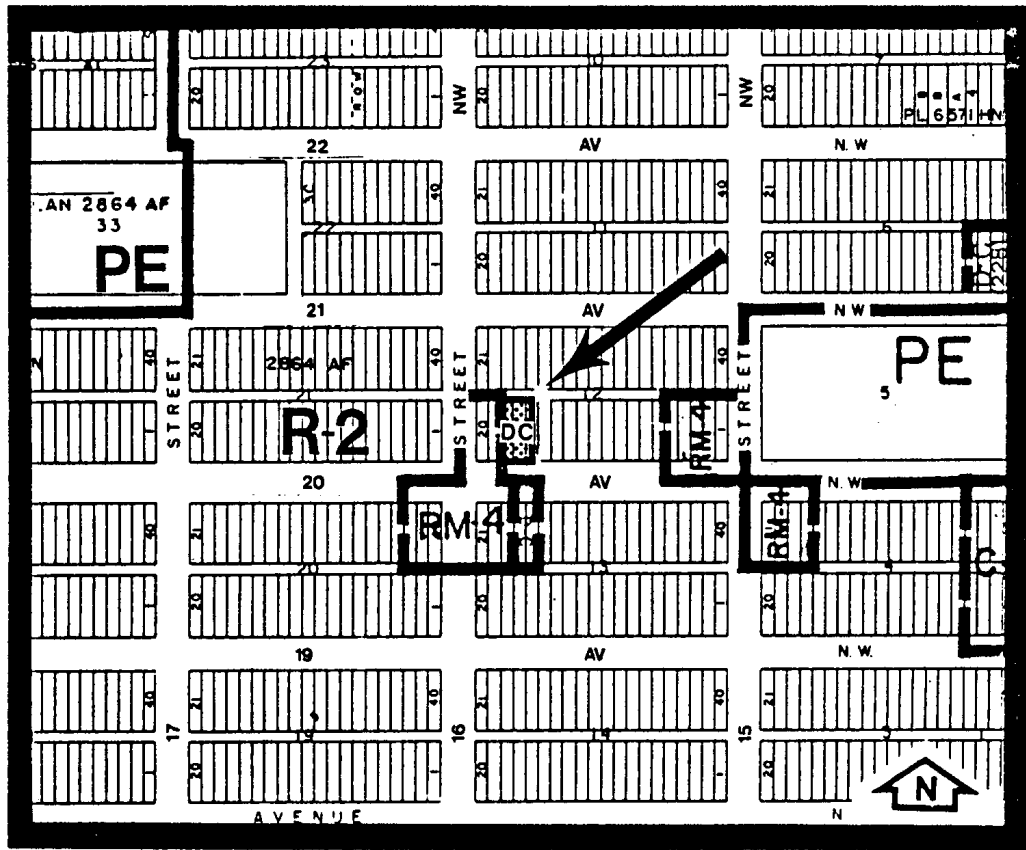

LAND USE GUIDELINES

The land use shall be for a maximum of 5 residential units in a stacked townhouse or townhouse form.

DEVELOPMENT GUIDELINES

Density

1. Maximum density shall be 72 units per hectare. (29 u.p.a.)

Yards

2. Front - a minimum of 6 m.
Side - a minimum of 1.2 m.
Rear - a minimum of 8 m.

Height

3. A maximum of two storeys not exceeding 9 metres at any eaveline.

Coverage

4. A maximum of 40% of the site area.

Garbage Storage

5. Garbage and waste material shall be stored in weatherproof and animal-proof containers in accordance with the Waste By-law and shall be visually screened from all adjacent sites and public thoroughfares.

Parking

6. A minimum of one parking stall for each residential unit shall be provided on site.

Development Plans

7. The Calgary Planning Commission when considering the project ensure that it is substantially in conformity with the rendering and material presented to City Council on 1980 May 13 in support of By-law No. 30Z80.