

**Amendment No. 81/83**  
**Bylaw No. 162Z81**  
Council Approval: 09 September 1981

**SCHEDULE B**

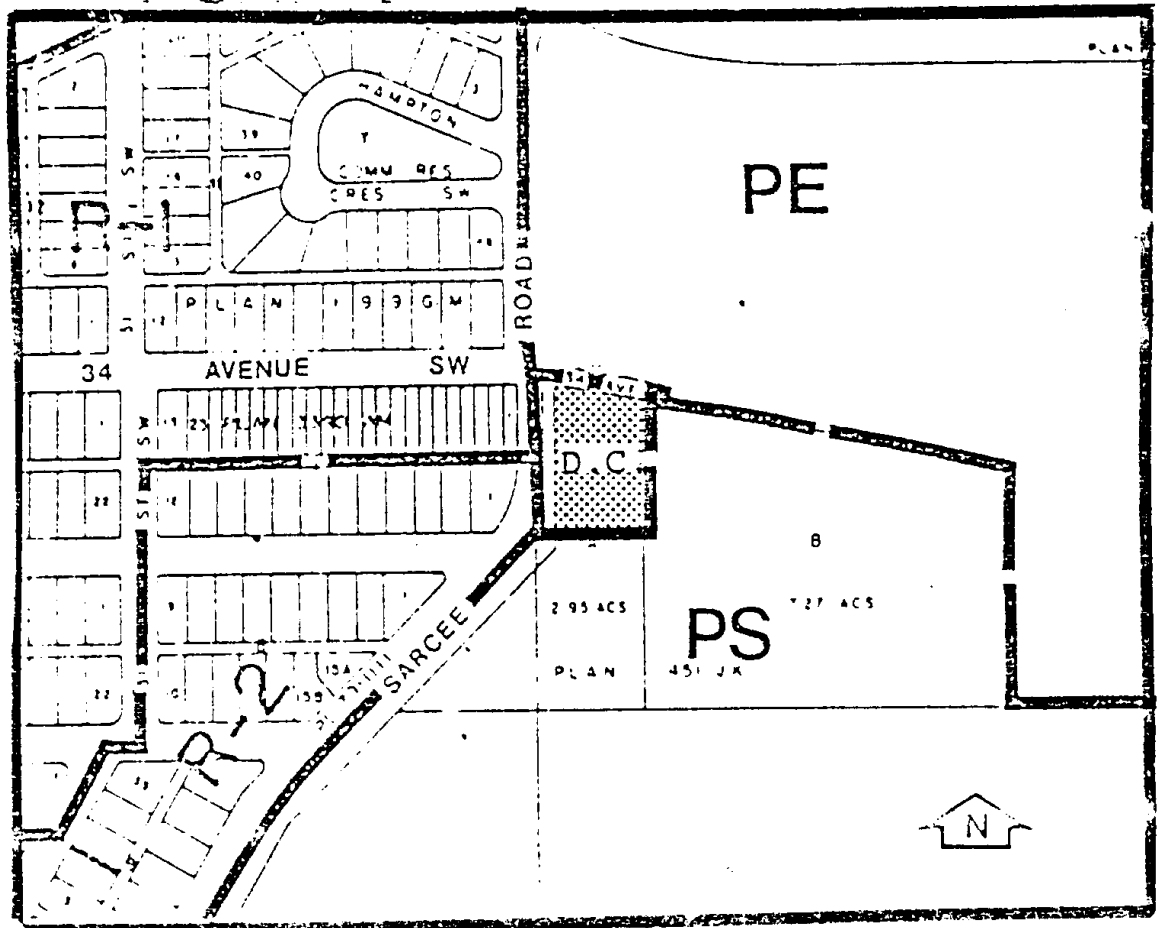

1. Land Use

The land use shall be for a senior citizen development.

2. Development Guidelines

The General Rules for Residential Districts contained in Section 20 of By-Law 2P80 and the Permitted and Discretionary Use Rules of the RM-4 District shall apply unless otherwise noted below:

(a) Parking

A minimum of 50% off-street parking shall be provided.