

Amendment No. 86/002
Bylaw No. 75Z86
Council Approval: 16 June 1986

SCHEDULE B

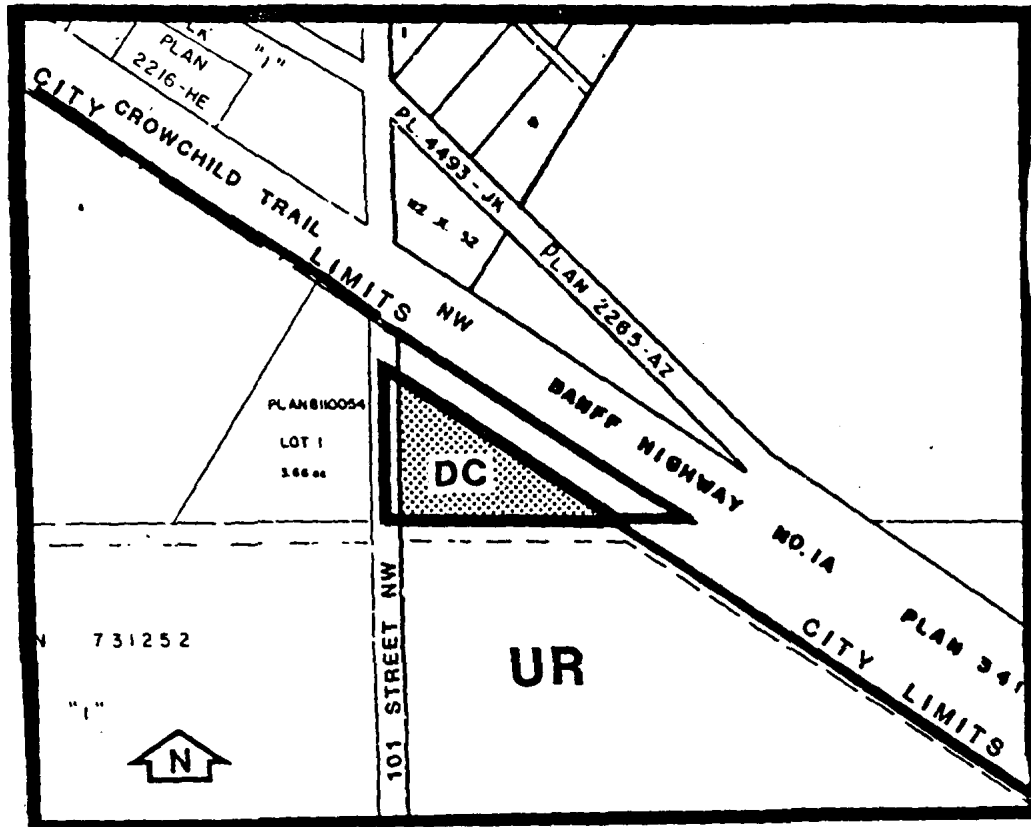

1. Land Use

The land use shall be for a single detached dwelling, accessory buildings and/or a daycare centre only.

2. Development Guidelines

The General Rules for Special Districts contained in Section 48 of By-law 2P80 and the Permitted and Discretionary Use Rules of the UR (Urban Reserve District) shall apply unless otherwise noted below.

a. Daycare Centre Capacity

A daycare centre shall be limited to a maximum of 50 children.

b. Development Plans

Approval of this application does not constitute approval of a development permit. Comprehensive plans, including building design, site layout, exterior finishes and colour, landscaping, parking and accesses shall subsequently be submitted to the Approving Authorities as part of a development permit application.