

Amendment No. 90/090
Bylaw No. 124Z90
Council Approval: 12 November 1990

SCHEDULE B

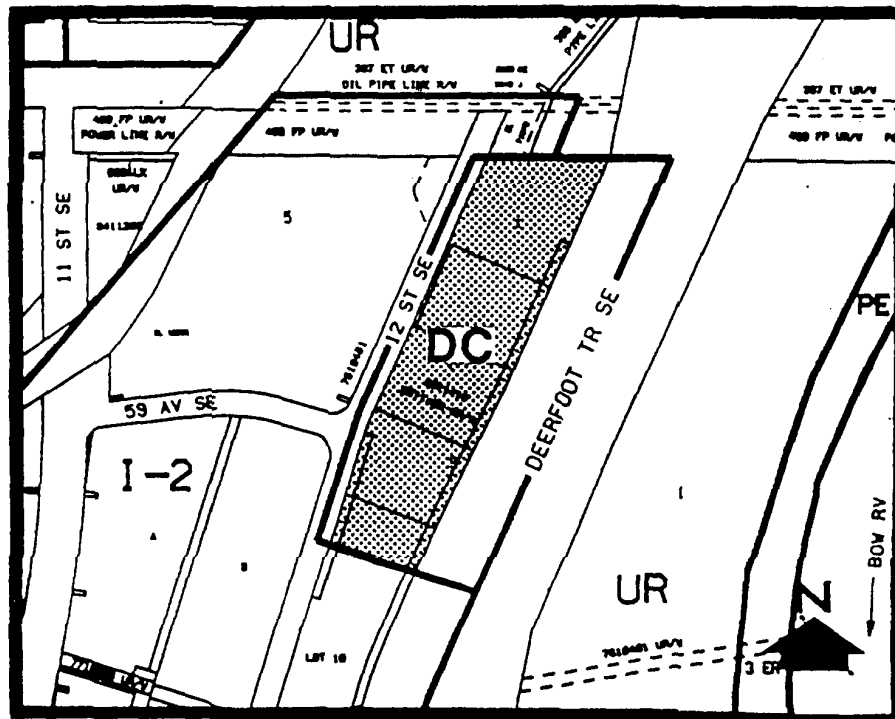

1. Land Use

The permitted and discretionary uses of the I-2 General Light Industrial District shall be permitted and discretionary uses respectively, with the additional discretionary use of custodial quarters.

2. Development Guidelines

The General Rules for Industrial Districts contained in Section 43 of By-law 2P80 and the Permitted and Discretionary Use Rules of the I-2 General Light Industrial District shall apply unless otherwise noted below.

a) Custodial Quarters Floor Area

The maximum gross floor area for the custodial quarters shall be 167 square metres (1800 sq. ft.).

b) Development Plans

Approval of this application does not constitute approval of a development permit. Comprehensive plans, including building design, site layout, exterior finishes and colour, landscaping, parking and access shall subsequently be submitted to the Approving Authority as part of a development permit application.