

Amendment No. 94/025
Bylaw No. 58Z94
Council Approval: 20 June 1994

SCHEDULE B

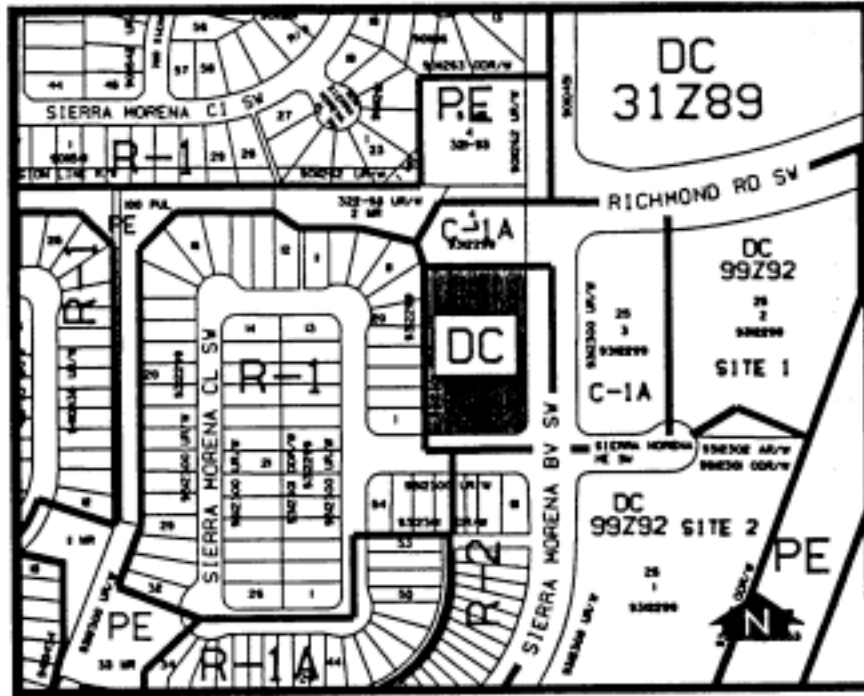

1. Land Use Guidelines

The Permitted and Discretionary Uses of the RM-1 Residential Low Density Multi-Dwelling District shall be the permitted and discretionary uses respectively with the additional Discretionary Use of semi-detached dwellings.

2. Development Guidelines

a) The General Rules for Residential Districts contained in Section 20 of By-law 2P80 and the Permitted and Discretionary Use Rules of the RM-1 Residential Low Density Multi-Dwelling District shall apply unless otherwise noted below.

b) Density

The maximum density shall be 30 units per hectare.

c) Development Plans

Approval of this application does not constitute approval of a development permit. Comprehensive plans, including building design, site layout, exterior finishes and colour, landscaping, and parking and accesses shall be submitted to the Approving Authority as part of a development permit application.

