

Amendment No. 95/083
Bylaw No. 7Z96
Council Approval: 12 February 1996

SCHEDULE B

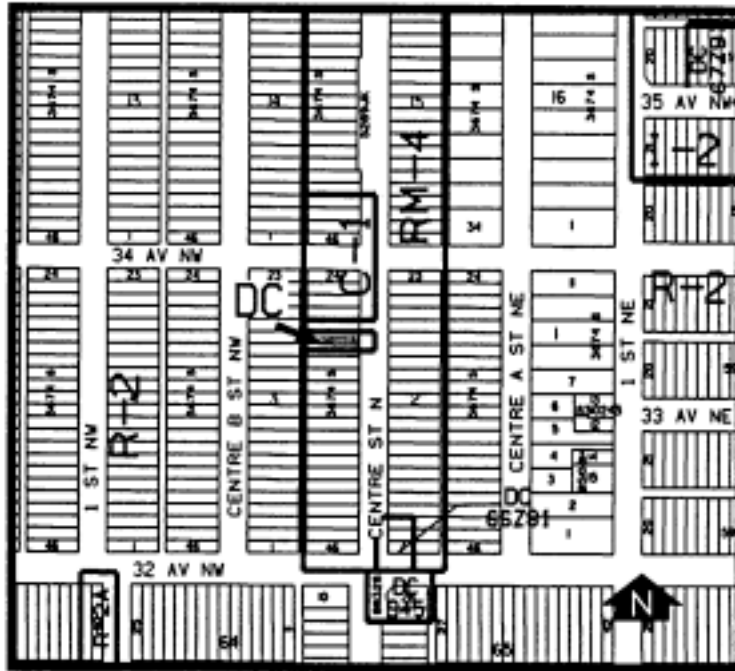

1. Land Use

The Permitted and Discretionary Uses of the RM-4 Residential Medium Density Multi-Dwelling District of Bylaw 2P80 shall be Permitted and Discretionary Uses respectively, with the additional Discretionary Uses of the assembly, repair and sale of clocks, watches and jewellery, within the building existing on the site on the date of passage of this bylaw only.

2. Development Guidelines

The General Rules for Residential Districts contained in Section 20 of Bylaw 2P80 and the Permitted and Discretionary Use Rules of the RM-4, Residential Medium Density Multi-Dwelling District shall apply. For Commercial Uses, the following shall apply.

a) Vehicular Access and Egress

Access and egress shall be to the satisfaction of the Director of Transportation and shall be restricted to Centre Street N.

b) Parking for Commercial Uses

A minimum of 3 on-site parking stalls shall be provided in association with any discretionary uses related to the manufacturing, repair and sale of clocks, watches and jewellery.

c) Fencing, Landscaping and Garbage Storage

Fencing, landscaping and garbage storage shall be to the satisfaction of the Development Authority.

d) Signage

i) Identification signs shall be allowed to the satisfaction of the Development Authority.

ii) A freestanding identification sign shall be allowed provided that:

- the area shall not exceed 1.2 m²; and
- the height shall not exceed 1.2 m.

iii) Temporary signs are not permitted.

e) Development Plans

Approval of this application does not constitute approval of a development permit. Comprehensive plans shall be submitted to the Development Authority as part of a development permit application.