

Amendment No. 97/031
Bylaw No. 71Z97
Council Approval: 21 July 1997

SCHEDULE B

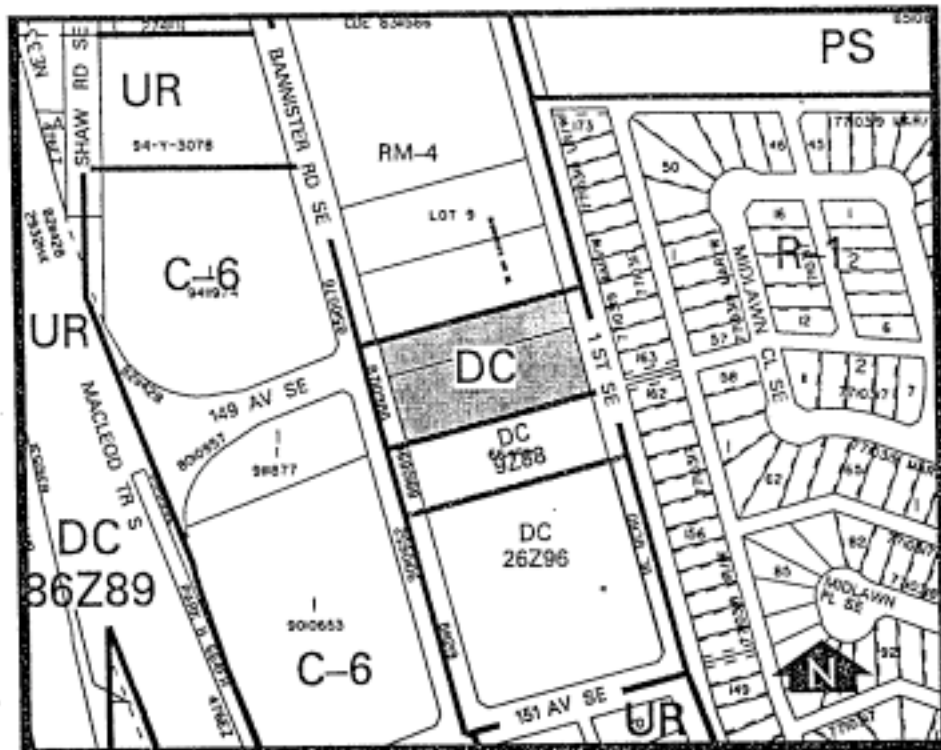

a. **Land Use**

Land Use shall be for a church and ancillary uses only.

b. **Development Guidelines**

The General Rules for Residential Districts contained in Section 20 of Bylaw 2P80 and the permitted and discretionary rules of the R-2 Residential Low Density District shall apply unless otherwise noted below:

i) **Church Capacity**

The maximum capacity for the church shall be 500 persons.

ii) **Access**

There shall be no vehicle access to 1 Street SE.

Amendment No. 97/031 Bylaw No. 71Z97

SCHEDULE B

CONTINUED

iii) Parking

A minimum of 100 parking stalls shall be provided but at no time shall the parking required of Bylaw 2P80 be relaxed .

iv) Development Plans

Approval of this application does not constitute approval of a development permit. Comprehensive plans including any phasing plan shall be submitted to the Approving Authority as part of a development permit application.

v) Landscaping

All areas of the site determined by the Approving Authority as not being for buildings, parking or access ways shall be landscaped to the satisfaction of the Approving Authority.

vi) Outdoor Noise

No form of outdoor sound systems, such as bells or speakers shall be allowed for this development.