

Amendment No. 97/124
Bylaw No. 46Z98
Council Approval: 11 May 1998

SCHEDULE B

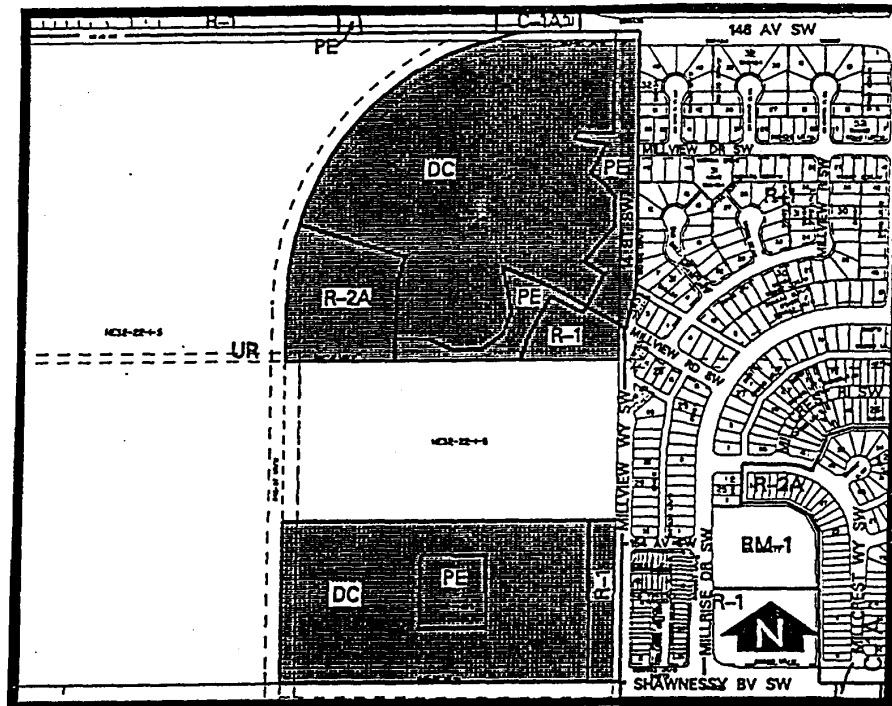

1. Land Use

The Permitted and Discretionary Uses of the R-1 Residential Single Detached District of Bylaw 2P80 shall be the Permitted and Discretionary uses respectively.

1. Development Guidelines

The General Rules for Residential District contained in Section 20 of Bylaw 2P80 and the Permitted and Discretionary Use rules of the R-1 District shall apply unless otherwise noted below:

1) Lot Width

- 1) The minimum lot width shall be 10.4 metres.

2) The minimum average lot width in a Plan of Subdivision shall be 11.0 metres.

2) Development Permits

Development Permit requirements for the Permitted and Discretionary Uses of this district shall be subject to Section 8 of By-law 2P80.