

Amendment No. 98/127
Bylaw No. 115Z99
Council Approval: 04 October 1999

SCHEDULE B

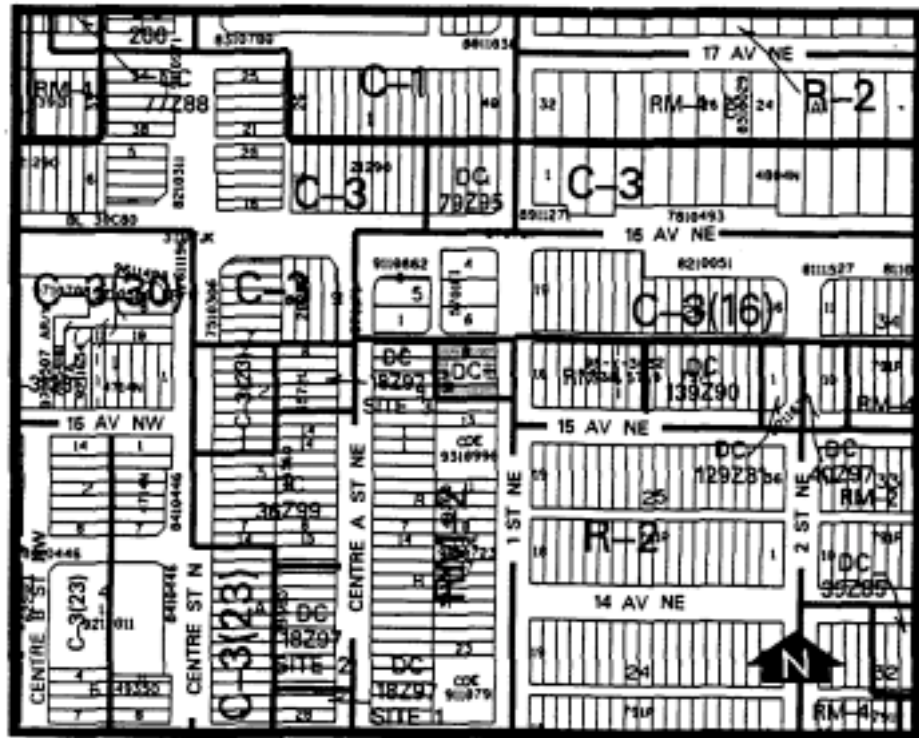

1. Land Use
The land use shall be for an apartment building only.
2. Development Guidelines
The General Rules for Residential Districts contained in Section 20 of Bylaw 2P80 and the Permitted and Discretionary Use Rules of the RM-4 Residential Medium Density Multi-Dwelling District shall apply unless otherwise noted below.
 - a. Density
The maximum number of dwelling units shall be 15.
 - b. Development Plans
Approval of this application does not constitute approval of a development permit. Comprehensive plans shall be submitted to the Development Authority as part of

a development permit application. In considering such an application, the Development Authority shall ensure the building design and site layout are consistent with the plans and renderings submitted to City Council during their consideration of the Bylaw.