

Amendment No. 98/086
Bylaw No. 63Z99
Council Approval: 22 June 1999

SCHEDULE B

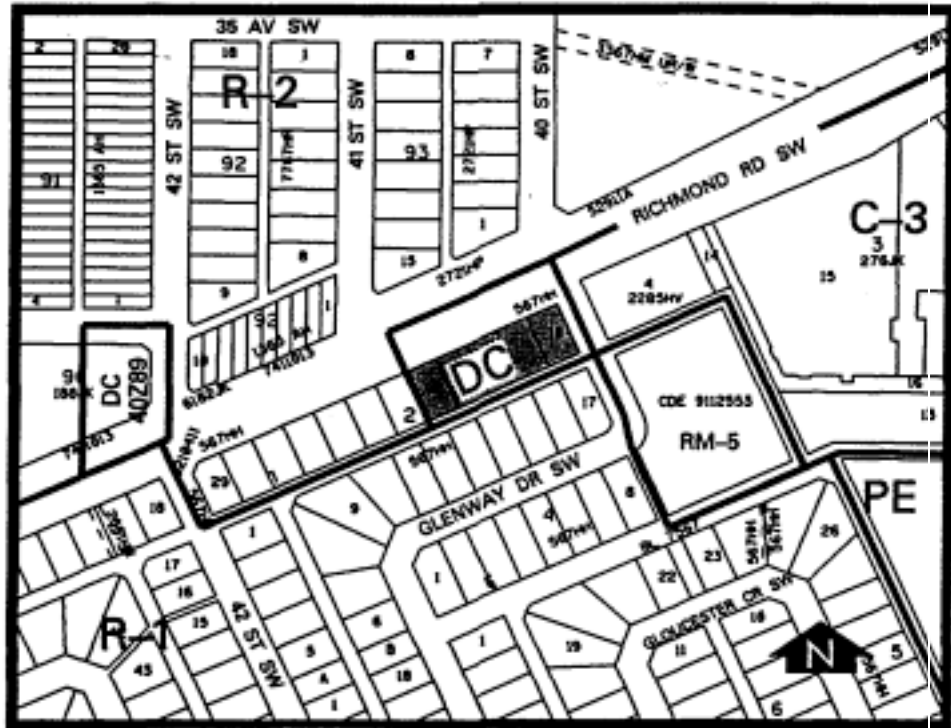

(1) Land Use

The land use shall be for a comprehensively designed building containing a church and apartment units as discretionary uses.

(2) Development Guidelines

The General Rules for Residential Districts contained in Section 20 of Bylaw 2P80 and the permitted and discretionary rules of RM-4 Residential Medium Density Multi-Dwelling District shall apply unless otherwise noted below:

(a) Number of Dwelling Units

The number of dwelling units shall be a maximum of 26.

(b) Parking

A minimum of 37 parking stalls, including 4 visitor stalls and 7 church stalls, in an underground parkade shall be provided in the project. A minimum of 22 surface church

parking stalls shall be provided in the project. Any increase in seating or operational capacity of the church shall require a proportional increase in parking provision.

(c) Development Plans

Approval of this application does not constitute approval of a development permit. Comprehensive plans shall be submitted to the Approving Authority as part of a development permit application. In considering such an application, the Approving Authority shall ensure the building design and site layout are consistent with the plans and renderings submitted to City Council during their consideration of this Bylaw.