

**Amendment No. 99/115**  
**Bylaw No. 15Z2000**  
**Council Approval: 17 January 2000**

**SCHEDULE B**

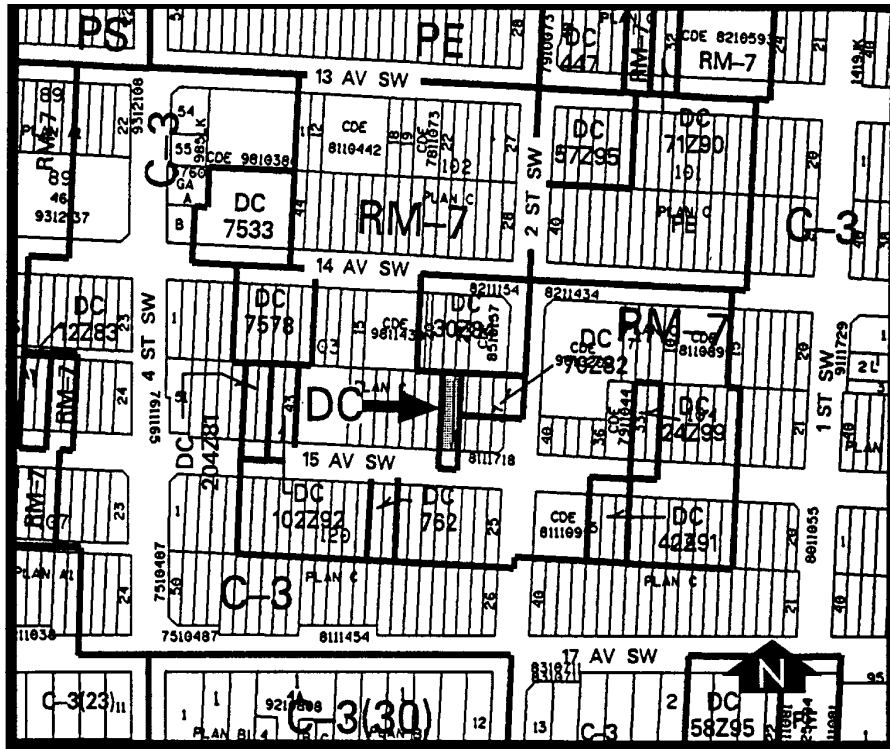

1. Land Use

The Permitted and Discretionary Uses of the RM-7 Residential High Density Multi-Dwelling District shall be the Permitted and Discretionary Uses respectively with the additional Discretionary Use of offices within the building existing on the site on the date of passage of this bylaw.

2. Development Guidelines

The General Rules for Residential Districts contained in Section 20 of Bylaw 2P80 and the Permitted and Discretionary Use Rules of the RM-7 Residential High Density Multi-Dwelling District shall apply unless otherwise noted below:

a) Signage

Signage shall not be illuminated and shall be limited in size, design and location and must be compatible with the residential neighbourhood, all to the satisfaction of the Development Authority.

b) Development Plans

Approval of this application does not constitute approval of a development permit. Comprehensive plans shall be submitted to the Development Authority as part of a development permit application.