

Amendment No. 99/007
Bylaw No. 45Z2000
Council Approval: 10 April 2000

SCHEDULE B

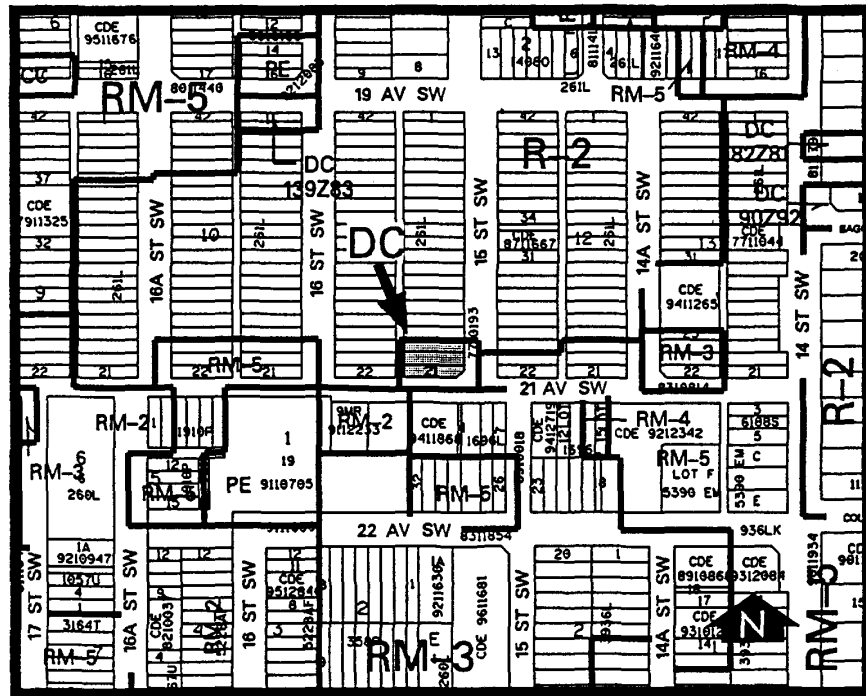

1. Land Use

The land use shall be for a comprehensively designed single-detached residential development.

2. Development Guidelines

The General Rules for Residential Districts contained in Section 20 of Bylaw 2P80 and the Permitted and Discretionary Use Rules of RM-2 Residential Low Density Multi-Dwelling District shall apply unless otherwise noted below:

a. Density

The number of dwelling units shall be a maximum of 4.

b. Development Plans

Approval of this application does not constitute approval of a development permit. Comprehensive plans including building design, site layout, floor plans, exterior finish

and colour, landscaping, parking, and accesses must be submitted to the Approving Authority as part of a development permit application. In considering such an application, the Approving Authority shall ensure that the building design, site layout, and density conform substantially to the plans and renderings submitted to City Council during their consideration of this Bylaw.