

Amendment # 2001/016
Bylaw # 41Z2001
Council Approval: 2001 June 11

SCHEDULE B

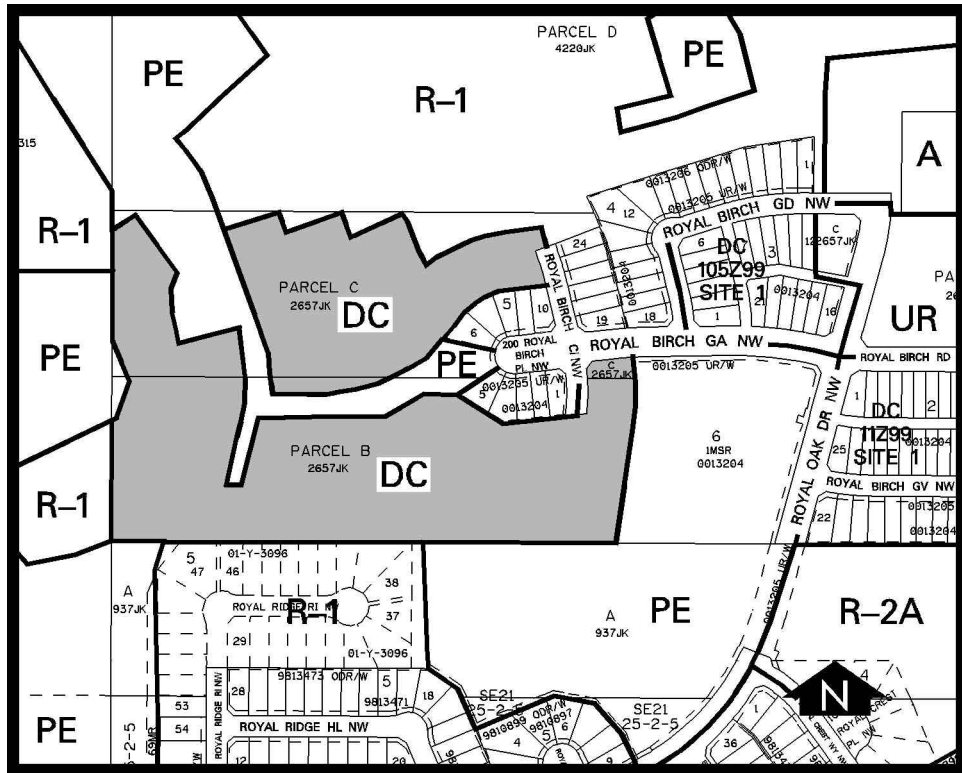

DC DIRECT CONTROL DISTRICT

1. Land Use

The Permitted and Discretionary Uses of the R-1A Residential Narrow Lot Single-Detached District of Bylaw 2P80 shall be the Permitted and Discretionary Uses respectively.

2. Development Guidelines

The General Rules for Residential Districts contained in Section 20 of Bylaw 2P80 and the Permitted and Discretionary Use Rules of the R-1A Residential Narrow Lot Single-Detached District shall apply unless otherwise noted below:

(a) Lot Width

- (i) A minimum of 10.5 metres, except a minimum of 9.75 metres may be provided where a minimum of 10.5 metres averaged over all the lots within a tentative plan is maintained.
- (ii) Sections 22.2(3)(e)(ii), (iii), and (iv), of the R-1A Residential Narrow Lot Single-Detached District shall apply.

(b) Building Height

A maximum of 9 metres, except a maximum of 10 metres where a building has an at-grade basement level entry.