

Amendment # LOC2002-0059
Bylaw # 97Z2002
Council Approval: 2002 November 04

SCHEDULE B

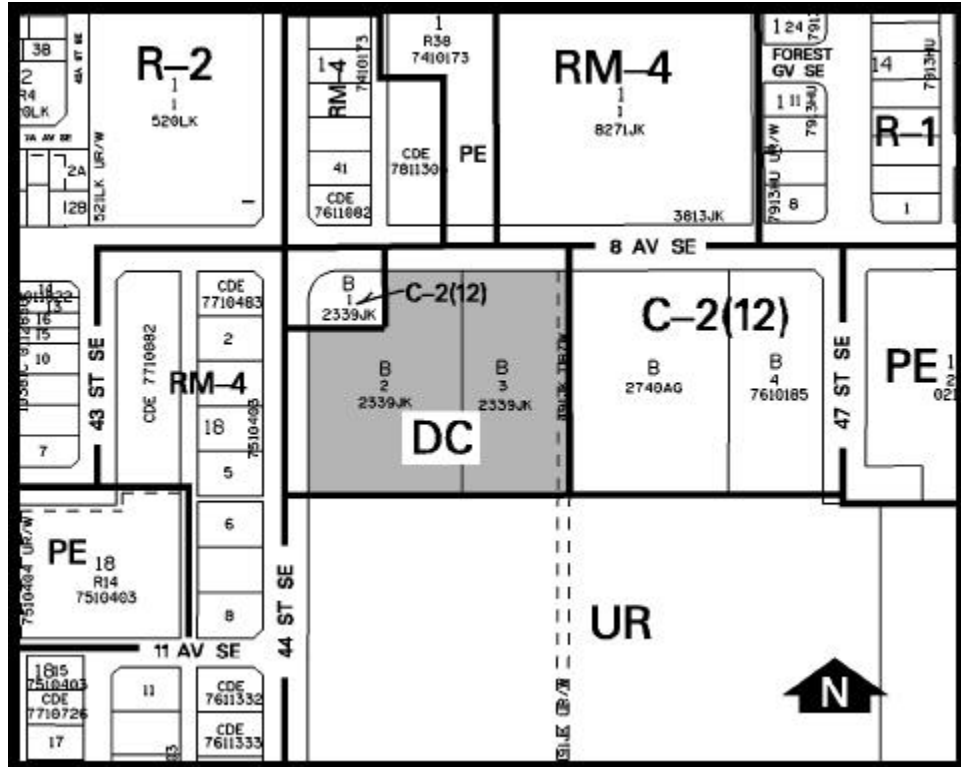

DC DIRECT CONTROL DISTRICT

1. Land Use

The Permitted and Discretionary Uses of the C-2(12) General Commercial District of Bylaw 2P80 shall be the Permitted and Discretionary Uses respectively with the additional Discretionary Use of a bottle return depot.

2. Development Guidelines

The General Rules for Commercial Districts contained in Section 33 of Bylaw 2P80 and the Permitted and Discretionary Use Rules of the C-2(12) General Commercial District shall apply unless otherwise noted below:

(a) Bottle Return Depot

(i) Floor Area

The maximum gross floor area shall not exceed 465 square metres.

(b) Screening

Visual screening to a minimum height of 1.8 metres shall be provided by a fence along the south property line to the satisfaction of the Approving Authority.

(c) Yards

Notwithstanding Sections 36(3)(a)(b) and (c) of Bylaw 2P80, the southerly 30 metres of yard abutting 44 Street SE shall be a minimum of 5 metres in depth.