

**Amendment # LOC2002-0047**  
**Bylaw # 15Z2003**  
Council Approval: January 20

**SCHEDULE B**

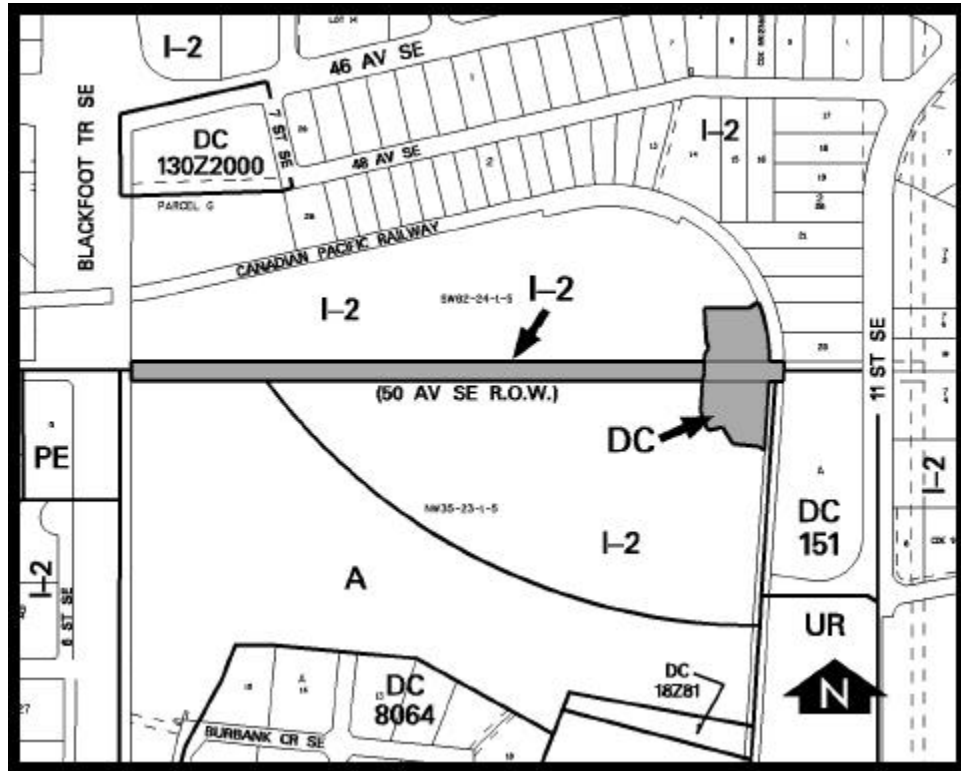

**DC DIRECT CONTROL DISTRICT**

1. Land Use

The Permitted and Discretionary Uses of I-2 General Light Industrial District shall be the Permitted and Discretionary Uses respectively (excluding intensive agriculture uses) with the additional Discretionary Use of outside storage which shall be ancillary to the primary use (meat processing plant) located on the site legally described as Block A, Plan 741 0362.

2. Development Guidelines

The General Rules for Industrial Districts contained in Section 43 of Bylaw 2P80 and the Permitted and Discretionary Use Rules of I-2 General Light Industrial District shall apply.