

**Amendment # LOC2003-0046**  
**Bylaw # 59Z2003**  
Council Approval: 2003 June 16

**SCHEDULE B**

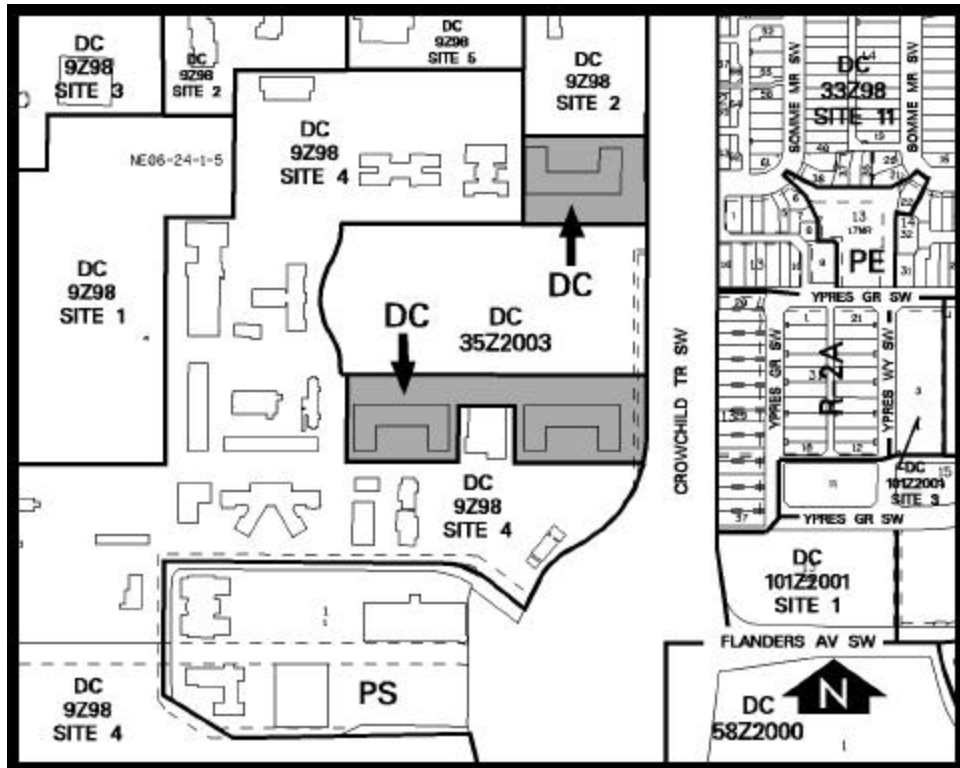

**DC DIRECT CONTROL DISTRICT**

1. Land Use

The Permitted and Discretionary Uses of the UR Urban Reserve District of Bylaw 2P80 shall be the Permitted and Discretionary Uses respectively, with the additional Permitted Uses, only within buildings existing on the site on the date of passage of this Bylaw:

- Athletic and recreational facilities
- Child care facilities
- Colleges and training centres
- Commercial schools
- Dormitories
- Hostels
- Lodging houses
- Medical clinics
- Offices
- Personal service businesses
- Private schools
- Special care facilities
- Universities

and the additional Discretionary Uses, only within buildings existing on the site on the date of passage of this Bylaw:

Restaurant/drinking establishment  
Restaurant – food service only

2. Development Guidelines

The General Rules for Special Districts contained in Section 48 of Bylaw 2P80 and the Permitted and Discretionary Use Rules of the UR Urban Reserve District shall be the Permitted and Discretionary Use Rules respectively unless otherwise noted below:

(a) Development Permits

No development permit for a permitted use shall be approved for more than five years; provided always that the term of a development permit shall not extend beyond 2008 January 19.

(b) Parking

Notwithstanding Section 18(1)(a) and (b) of Bylaw 2P80, parking for all uses shall be provided within 250 metres of the building or development area.

(c) Subdivision

No subdivision of land, including bare land condominiums, shall be allowed under this land use designation.

(d) New Development

No new buildings or additions to existing buildings shall be allowed.