

Amendment # LOC2003-0045
Bylaw # 70Z2003
Council Approval: 2003 July 21

SCHEDULE B

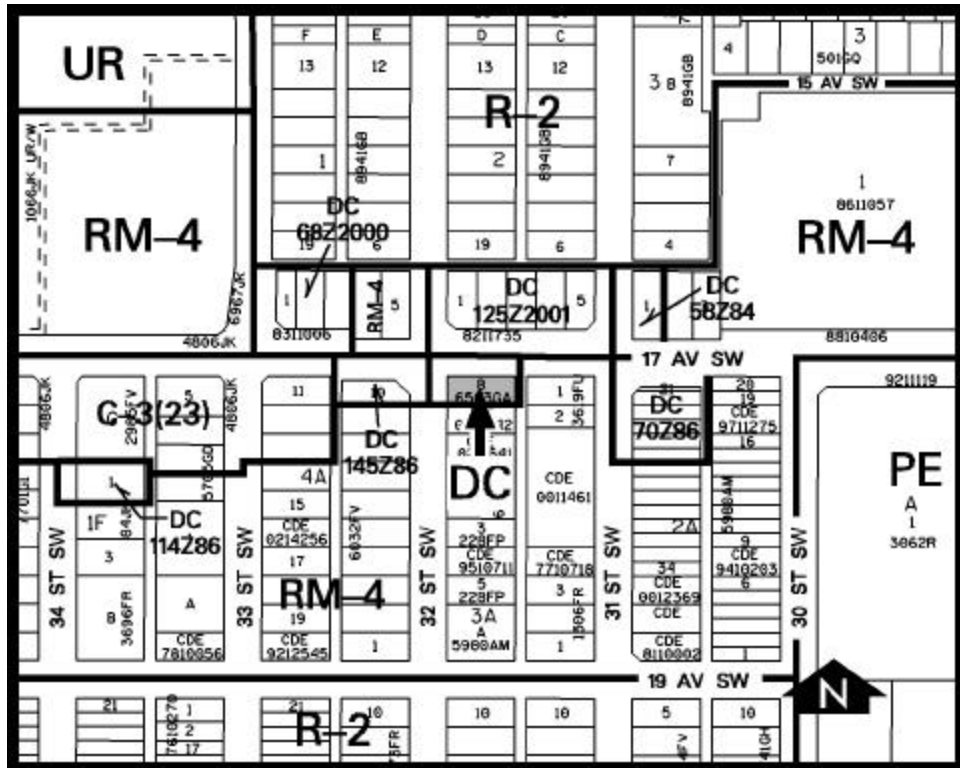

DC DIRECT CONTROL DISTRICT

1. Land Use
 - (a) Permitted Uses
 - Home occupations – Class 1
 - Utilities

(b) Discretionary Uses

Dwelling units
Home occupations – Class 2 (N.P.)
Medical clinic
Offices
Personal service businesses

2. Development Guidelines

The General Rules for Commercial Districts contained in Section 33 of Bylaw 2P80 and the Permitted and Discretionary Use Rules of the C-1 Local Commercial District shall apply unless otherwise noted below.

(a) Commercial Development

Any change in intensity of use or any change of use shall require a development permit application. No building use confirmations shall be issued for this site.

(b) Parking

Parking requirements shall be to the satisfaction of the Approving Authority.