

Amendment # LOC2003-0123
Bylaw # 37Z2004
Council Approval: 2004 May 31

SCHEDULE B

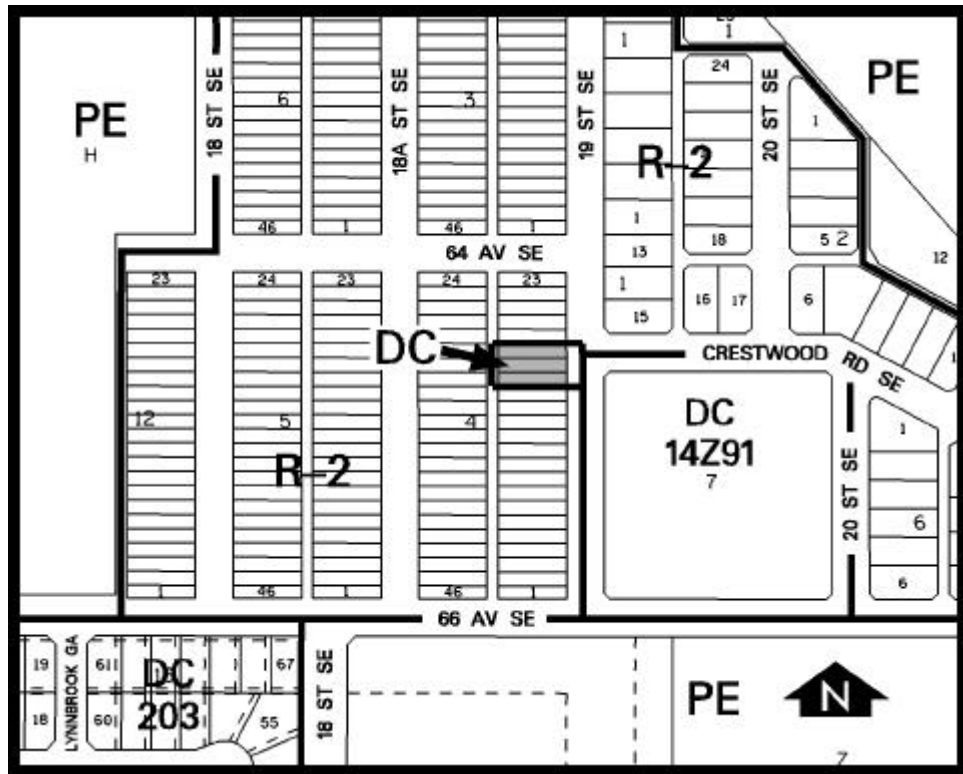

DC DIRECT CONTROL DISTRICT

1. Land Use

The Permitted and Discretionary Uses of the R-2 Residential Low Density District of Bylaw 2P80 shall be the Permitted and Discretionary Uses respectively with the additional Discretionary Use of child care facility within the building existing on site on the date of passage of this Bylaw.

2. Development Guidelines

The General Rules for Residential Districts contained in Section 20 of Bylaw 2P80 and the Permitted and Discretionary Rules of the R-2 Residential Low Density District shall apply unless otherwise noted below.

(a) Child Care Capacity

The child care facility is restricted to a maximum of 30 children at any one time.

(b) Signage

Signage shall be limited to one free standing non-illuminated sign only with a maximum size of 0.6 x 1.2 metres, to the satisfaction of the Approving Authority.