

BYLAW NUMBER 71D2012

**BEING A BYLAW OF THE CITY OF CALGARY
TO AMEND THE LAND USE BYLAW 1P2007
(LAND USE AMENDMENT LOC2012-0039)

WHEREAS it is desirable to amend the Land Use Bylaw Number 1P2007 to change the land use designation of certain lands within the City of Calgary;

AND WHEREAS Council has held a public hearing as required by Section 692 of the Municipal Government Act, R.S.A. 2000, c.M-26 as amended;

NOW, THEREFORE, THE COUNCIL OF THE CITY OF CALGARY ENACTS AS FOLLOWS:

1. The Land Use Bylaw, being Bylaw 1P2007 of the City of Calgary, is hereby amended by deleting that portion of the Land Use District Map shown as shaded on Schedule "A" to this Bylaw and substituting therefor that portion of the Land Use District Map shown as shaded on Schedule "B" to this Bylaw, including any land use designation, or specific land uses and development guidelines contained in the said Schedule "B".
2. This Bylaw comes into force on the date it is passed.

READ A FIRST TIME THIS 3RD DAY OF DECEMBER, 2012.

READ A SECOND TIME THIS 3RD DAY OF DECEMBER, 2012.

READ A THIRD TIME THIS 3RD DAY OF DECEMBER, 2012.



MAYOR
SIGNED THIS 3RD DAY OF DECEMBER, 2012.



ACTING CITY CLERK
SIGNED THIS 3RD DAY OF DECEMBER, 2012.

AMENDMENT LOC2012-0039
BYLAW NUMBER 71D2012

SCHEDULE A

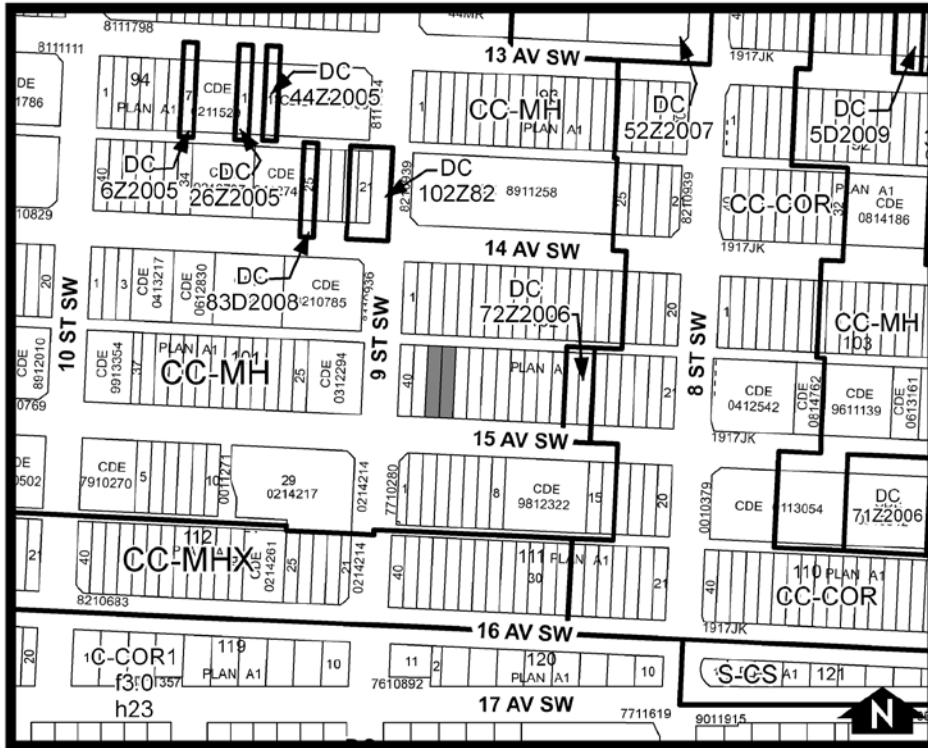

AMENDMENT LOC2012-0039
BYLAW NUMBER 71D2012

SCHEDULE B

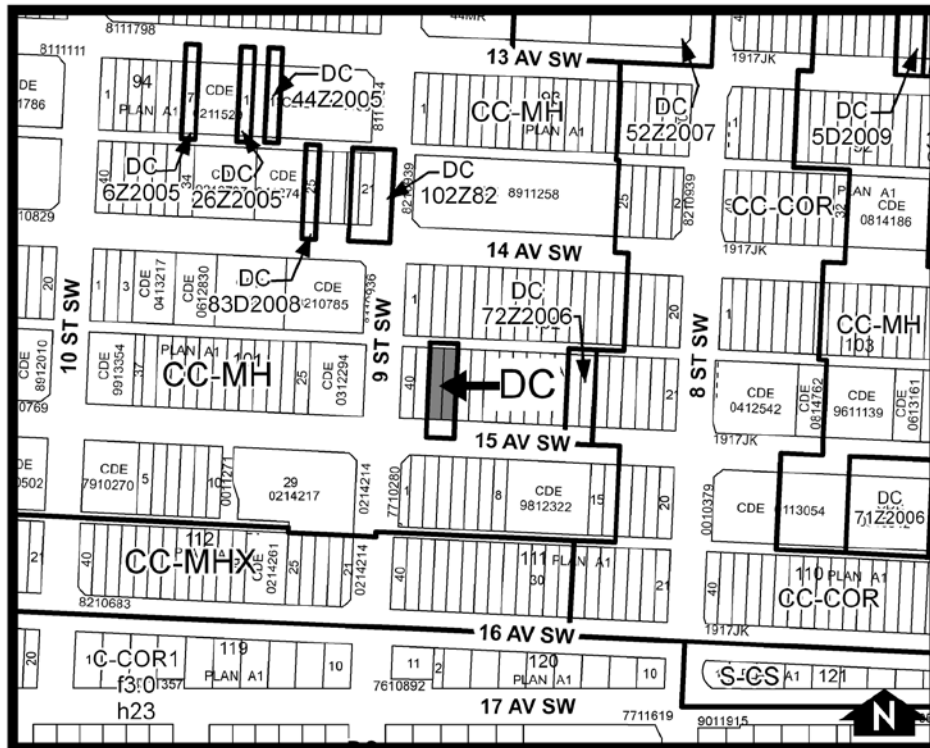

DC DIRECT CONTROL DISTRICT

Purpose

- 1 This Direct Control District is intended to provide for:
 - (a) an **Office** to be located only in the **building** as of the effective date of this Bylaw; and
 - (b) the retention of the **permitted** and **discretionary** uses of the Centre City Multi-Residential High Rise District (CC-MH).

**AMENDMENT LOC2012-0039
BYLAW NUMBER 71D2012**

Compliance with Bylaw 1P2007

- 2 Unless otherwise specified, the rules and provisions Parts 1, 2, 3 and 4 of Bylaw 1P2007 apply to this Direct Control District.

Reference to Bylaw 1P2007

- 3 Within this Direct Control District, a reference to a section or Part of Bylaw 1P2007 is deemed to be a reference to the section or Part as amended from time to time.

Permitted Uses

- 4 The ***permitted uses*** of the Centre City Multi-Residential High Rise District (CC-MH) of Bylaw 1P2007 are the ***permitted uses*** in this Direct Control District.

Discretionary Uses

- 5 The ***discretionary uses*** of the Centre City Multi-Residential High Rise District (CC-MH) of Bylaw 1P2007 are the ***discretionary uses*** in this Direct Control District with the addition of:

- (a) **Office** within the ***building*** existing on the site at the time of passage of this Direct Control District bylaw.

Bylaw 1P2007 District Rules

- 6 Unless otherwise specified, the rules of the Centre City Multi-Residential High Rise District (CC-MH) of Bylaw 1P2007 apply in this Direct Control District.

Signage

- 7 (1) A maximum of one **Freestanding Sign** may be located on the site; and
(2) The maximum ***sign area*** of a **Freestanding Sign** is 1 square metre.