

BYLAW NUMBER 90D2015

**BEING A BYLAW OF THE CITY OF CALGARY
TO AMEND THE LAND USE BYLAW 1P2007
(LAND USE AMENDMENT LOC2014-0168)**

WHEREAS it is desirable to amend the Land Use Bylaw Number 1P2007 to change the land use designation of certain lands within the City of Calgary;

AND WHEREAS Council has held a public hearing as required by Section 692 of the *Municipal Government Act*, R.S.A. 2000, c.M-26 as amended;

NOW, THEREFORE, THE COUNCIL OF THE CITY OF CALGARY ENACTS AS FOLLOWS:

1. The Land Use Bylaw, being Bylaw 1P2007 of the City of Calgary, is hereby amended by deleting that portion of the Land Use District Map shown as shaded on Schedule "A" to this Bylaw and substituting therefor that portion of the Land Use District Map shown as shaded on Schedule "B" to this Bylaw, including any land use designation, or specific land uses and development guidelines contained in the said Schedule "B".
2. This Bylaw comes into force on the date it is passed.

READ A FIRST TIME THIS 15TH DAY OF JUNE, 2015.

READ A SECOND TIME THIS 15TH DAY OF JUNE, 2015.

READ A THIRD TIME THIS 15TH DAY OF JUNE, 2015.

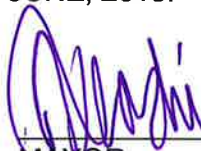

MAYOR

SIGNED THIS 15TH DAY OF JUNE, 2015.



ACTING CITY CLERK

SIGNED THIS 15TH DAY OF JUNE, 2015.

SCHEDULE A

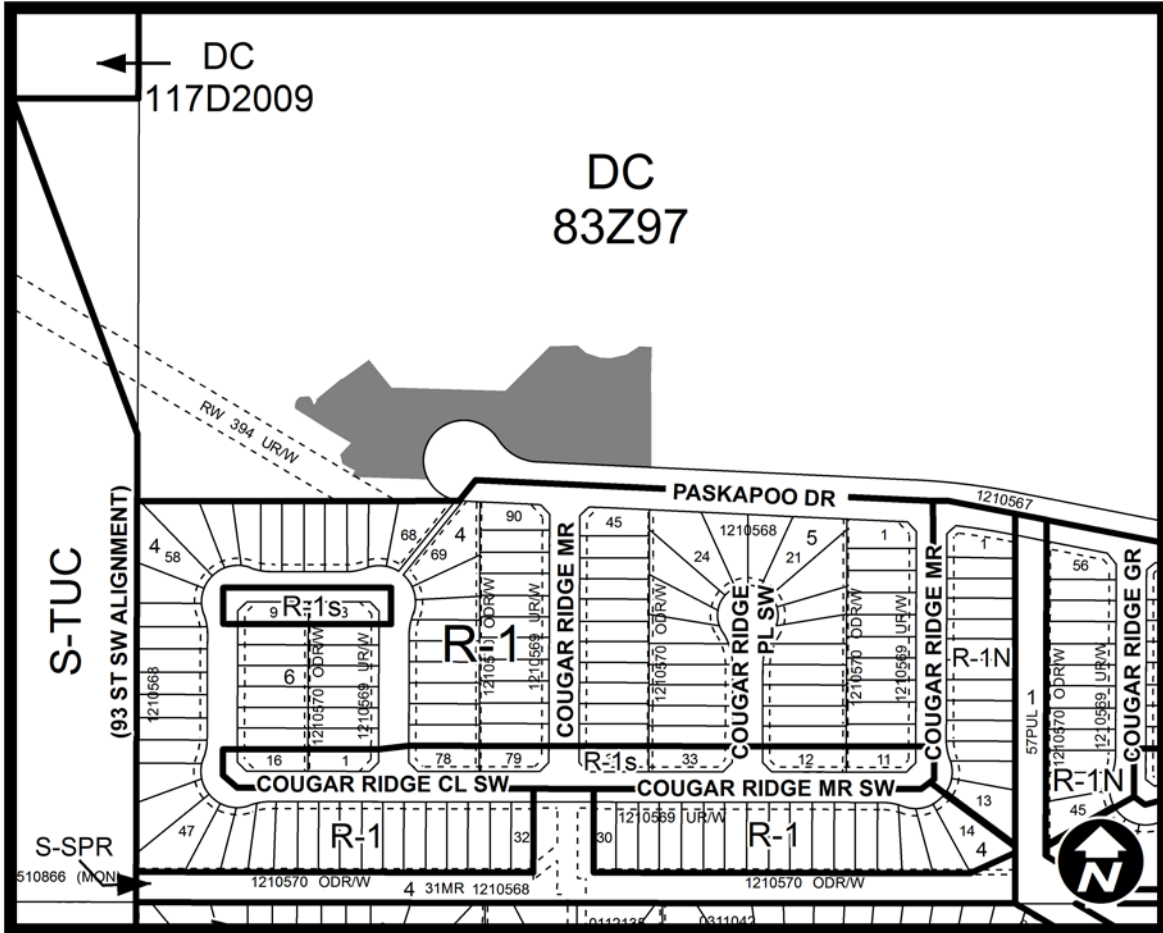

SCHEDULE B

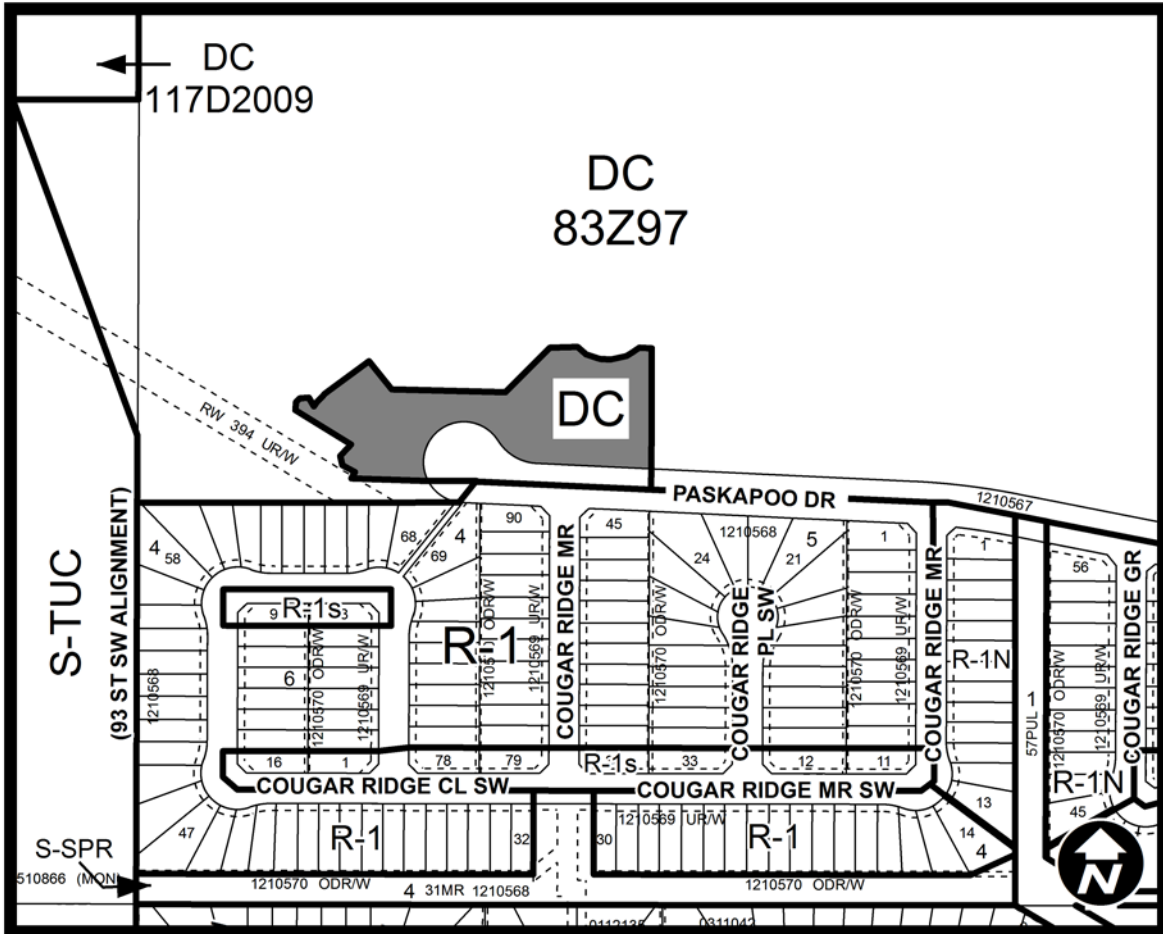

DC DIRECT CONTROL DISTRICT

Purpose

- 1 This Direct Control District is intended to accommodate:
 - (a) the use of a **Child Care Service** within an existing **building**;
 - (b) a range or indoor and outdoor recreation **uses**;

**AMENDMENT LOC2014-0168
BYLAW NUMBER 90D2015**

- (c) small scale food service **uses** that are existing **uses** at Canada Olympic Park; and;
- (d) **Utilities.**

Compliance with Bylaw 1P2007

- 2** Unless otherwise specified, the rules and provisions of Parts 1, 2, 3 and 4 of Bylaw 1P2007 apply.

Reference to Bylaw 1P2007

- 3** Within this Direct Control District, a reference to a section of Bylaw 1P2007 is deemed to be a reference to the section as amended from time to time.

Bylaw 1P2007 District Rules

- 4** Unless otherwise specified, the rules of the Special Purpose – Recreation (S-R) District of Bylaw 1P2007 apply in this Direct Control District.

Permitted Uses

- 5** The **permitted uses** of the Special Purpose – Recreation (S-R) District of Bylaw 1P2007 are the **permitted uses** in this Direct Control District with the addition of:

- (a) **Sign – Class B;**
- (b) **Sign – Class D;** and
- (c) **Utilities Linear;**

- 6** The following uses are **permitted uses** in this Direct Control District if they are located within existing **buildings**

- (a) **Child Care Service;**

Discretionary Uses

- 7** The following **uses** listed below are the **discretionary uses** in this Direct Control District:

- (a) **Sign – Class F;**
- (b) **Accessory Food Service;**
- (c) **Child Care Service;**
- (d) **Within an existing building Child Care Service - Addition**
- (e) **Food Kiosk;**
- (f) **Outdoor Recreation Area;**
- (g) **Storage Yard;** and
- (h) **Utility Building.**

Landscaping

- 8** Landscaping per section 1049, 1050 and 1051 of Bylaw 1P2007, may only be required where new **buildings** or additions to existing **buildings** are proposed.

Floor Area Ratio

9 The maximum *floor area ratio* is 1.0.

Building Height

10 The maximum *building height* is 14.0 metres.

Parking

11 The minimum number of *motor vehicle parking stalls* required in this Direct Control District shall be the minimum as required in Bylaw 1P2007.